

TIMER CONTROLLED CONDENSATE DRAIN - TD16M

DESCRIPTION

TD16M timer controlled condensate drain has been developed for reliable removal of condensate or other liquid from compressed air system⁽¹⁾. Discharge intervals can be set with two adjustment knobs. TD16M drain is available in several types based on operating pressure and operating medium.



APPLICATIONS⁽²⁾

- Air Compressor (piston or screw)
- After-cooler
- Cyclone condensate separator
- Pressure vessel/Air tank
- Air dryer
- Air filter

⁽¹⁾For any other technical gas please contact us or your local dealer

⁽²⁾TD16M can be used in variety of applications. For applications not listed please contact us or your local dealer.

TECHNICAL SPECIFICATIONS⁽³⁾

Operating temperature	1,5 - 65 °C	35 - 149 °F
Operating pressure (Standard version)	0 - 16 bar(g)	0 - 232 psi
Protection class	IP65	
Supply voltage	115V / 230V (±10%), AC, 50/60Hz	
Coil power	18VA (holding), 36 (inrush)	
Cable dimensions	3 x 0,75mm ²	
Mass (timer + valve)	0,35kg	
Mass (strainer)	0,23kg	
Valve	Direct acting solenoid valve, 2/2, Normally closed	
Connector	DIN EN 175301-803 form A	
Time ON	0,5s - 10s	
Time OFF	0,5min - 45min	
Indicator	LED light "Green- Valve open"	
Max. discharge capacity	95 l/h	

⁽³⁾Standard version (TD16M), at 7 barg

MATERIALS⁽⁴⁾

Housing material	PA6, 30% glass fiber
Screws	Steel-zinc plated
Coil	Epoxi coated
Valve	Brass (stainless steel plunger)
Housing sealing	NBR
Valve sealing	FKM
Strainer	Brass
Internal strainer mesh	Stainless steel

⁽⁴⁾Standard version (TD16M)

PARTS LIST

1	Timer TDm
2	Cover
3	Valve
4	Strainer
5	Cover gasket
6	Valve gasket
7	Screw

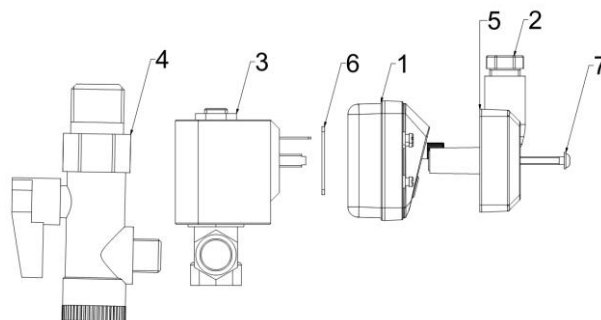

DIMENSIONS

A	77 mm
B	93 mm
C	79 mm
D	63 mm
E	55 mm

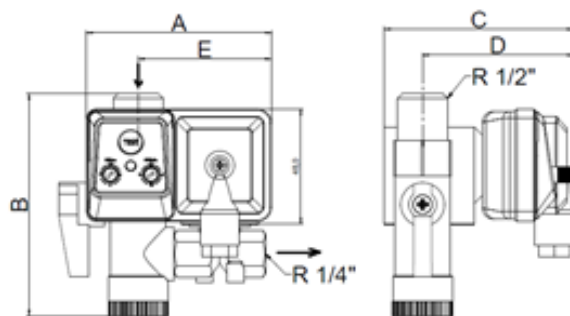

TYPES

	Voltage	MAX. Pressure [barg]/[psig]	Medium	Strainer*	Flow coefficient Kvs [l/min]
TD16M 115 VAC	115 V +/- 10%	16 / 232	Air, water, oil	Yes	2,4
TD16M 230 VAC	230 V +/- 10%	16 / 232	Air, water, oil	Yes	2,4
TD25M 115 VAC	115 V +/- 10%	25/ 362	Air, water, oil	Yes	1,5
TD25M 230 VAC	230 V +/- 10%	25/ 362	Air, water, oil	Yes	1,5
TD50M 115 VAC	115 V +/- 10%	50/ 735	Air, water, oil	Yes	0,7
TD50M 230 VAC	230 V +/- 10%	50/ 735	Air, water, oil	Yes	0,7
TD150M 115 VAC	115 V +/- 10%	150/2175	Air, water, oil	No	0,7
TD150M 230 VAC	230 V +/- 10%	150/2175	Air, water, oil	No	0,7
TD16Mcr 115 VAC	115 V +/- 10%	16 / 232	Agressive fluids	No	3,4
TD16Mcr 230 VAC	230 V +/- 10%	16 / 232	Agressive fluids	No	3,4

*Strainer max working pressure is 50 barg.

APPROXIMATE CALCULATION OF DISCHARGE CAPACITY

$$Q = Kvs \times \sqrt{\Delta p} \times \left(\frac{\frac{TimeON}{60}}{\frac{TimeON}{60} + Time OFF} \right)$$

Q-Discharge capacity [l/min], Kvs-Flow coefficient, Δp-pressure difference [bar], Time ON and Time OFF are determined by adjustment knobs, the range of each timer is specified in technical specification (page 1).

MAINTENANCE

INFORMATION IN THIS DOCUMENT IS SUBJECT TO CHANGE WITHOUT NOTICE

	Our quality management system is certified by BUREAU VERITAS in conformity with ISO 9001:2008 Reg. number: 200285
---	--

Clean strainer (filter mesh) at least every six months. If necessary disassemble and clean the valve.

INFORMATION IN THIS DOCUMENT IS SUBJECT TO CHANGE WITHOUT NOTICE

	<p>Our quality management system is certified by BUREAU VERITAS in conformity with ISO 9001:2008 Reg. number: 200285</p>	
---	--	--